

**SITE ELECTRICAL PLAN NOTES**

1. CONDUIT SWEEPS RISING INTO LOAD CENTER CABINET PADS, UTILITY POLE RISERS, ETC. SHALL BE GALVANIZED STEEL CONDUIT & SHALL BE A MINIMUM OF .36" BEND.
2. THE LOAD CENTER CABINET PAD SHALL BE CONSTRUCTED BY THE ELECTRICAL CONTRACTOR. THE GROUNDING GRID SHALL BE PROVIDED BY THE ELECTRICAL CONTRACTOR.
3. ALL SECONDARY CONDUCTORS & SECONDARY LUGS SHALL BE PROVIDED BY THE ELECTRICAL CONTRACTOR. FINAL CONNECTION OF SECONDARY CABLES SHALL BE PERFORMED BY NATIONAL GRID.
4. EACH ITEM REFERRED TO THIS NOTE IS A PAD MOUNTED LOAD CENTER CABINET PROVIDED BY THE ELECTRICAL CONTRACTOR. REFER TO LOAD CENTER CABINET DETAILS ON DRAWING SE-3 FOR WORK REQUIRED BY THE GENERAL AND ELECTRICAL CONTRACTORS.
5. EACH ITEM REFERRED TO THIS NOTE IS AN EXISTING "TYPE LP" POLE MOUNTED LUMINAIRE TO BE RELOCATED (ALONG WITH ITS ASSOCIATED BRANCH CIRCUIT) TO THE LOCATION INDICATED ON THE PLAN. THE GENERAL CONTRACTOR SHALL PROVIDE A NEW POLE BASE AS PER THE TYPICAL DETAIL ON DRAWING SE-2.
6. ALL EMPTY CONDUITS SHALL BE PROVIDED WITH A NYLON PULL WIRE FOR THEIR ENTIRE LENGTH.
7. EXTEND SECONDARY CONDUITS AND CONDUCTORS UP TO LOAD CENTER CABINET MAIN SWITCH AND CONNECT TO TERMINALS.
8. EXTEND 1 1/4" CONDUIT INTO LOAD CENTER CABINET. STUB CONDUIT UP 6" ABOVE TOP OF PAD. CAP AND SEAL.

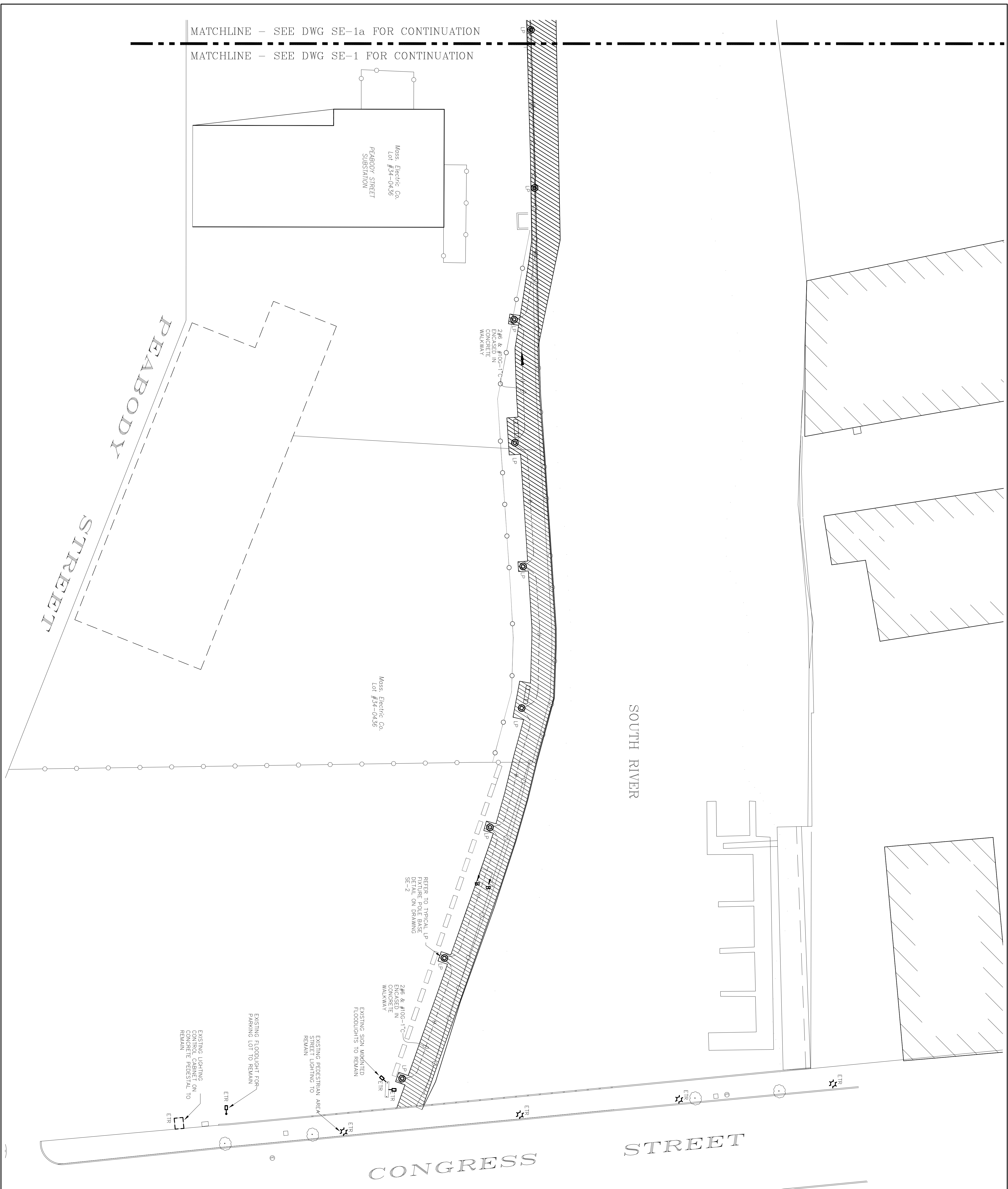

MATCHLINE - SEE DWG SE-1a FOR CONTINUATION  
 MATCHLINE - SEE DWG SE-1 FOR CONTINUATION

Mass Electric Co  
 Lot #54-0436  
 PEABODY STREET  
 SUBSTATION

Mass Electric Co  
 Lot #54-0436

REFER TO TYPICAL LP  
 FIXTURE POLE BASE  
 DETAIL ON DRAWING  
 SE-2

EXISTING SIGN MOUNTED  
 FLOODLIGHTS TO REMAIN

EXISTING PEDESTRIAN AREA  
 STREET LIGHTING TO  
 REMAIN

EXISTING LIGHTING  
 CONTROL CABINET ON  
 CONCRETE PEDESTAL TO  
 REMAIN

EXISTING FLOODLIGHT FOR  
 PARKING LOT TO REMAIN

PEABODY  
 STREET

SOUTH RIVER

CONGRESS  
 STREET

**ISSUED FOR DRAFT  
 NOT FOR CONSTRUCTION**  
 DATE ISSUED: **AUG 2008**  
 VINE ASSOCIATES, INC.

**Engineered Building Systems, Inc.**  
 Consulting Engineers  
 22 MANCHESTER ROAD, SUITE 8A  
 DEXTER, MA 01938  
 TEL: (603) 251-4338  
 FAX: (603) 251-4335  
 EMail: eb@ebshand.net

**SITE ELECTRICAL PLAN**

**SALEM HARBORWALK  
 DERBY STREET TO CONGRESS STREET  
 SALEM, MASSACHUSETTS**

DES.	CHK.	RFG	DR.	VAL
MIT	RFG	BL	FILE NO.	25035
SCALE	APP'D	DATE		
1"=20'	RFG	AUG. 2008	<b>SE-1a</b>	

**Vine ASSOCIATES, INC.**  
 372 WEDBROOK STREET  
 NEWBURYPORT, MA 01950  
 TEL: (978) 465-1428  
 FAX: (978) 465-2849

148 OLD BRIDGE STREET  
 HINGHAM, MA 02043  
 TEL: (781) 734-2350  
 FAX: (781) 734-2375

34 BEACH STREET  
 MONMOUTH BEACH, NJ 08853  
 TEL: (508) 724-0380  
 FAX: (508) 745-9391