

HIGHWAY GUARD RAIL
NONE

DRAINAGE DETAILS
SEE BELOW

WATER SUPPLY ALTERATIONS
PROP. 12" WATER MAIN FROM
STA. 32+93 TO 44+97

TRAFFIC SIGNAL CONDUIT
SEE TRAFFIC PLAN

LANDSCAPING DETAILS
SEE BELOW

SALEM BRIDGE STREET			
STATE	FED. AID PROJ. NO.	SHEET NO.	TOTAL SHEETS
MASS.		9	81
PROJECT FILE NO. 601017			
CONSTRUCTION PLAN			

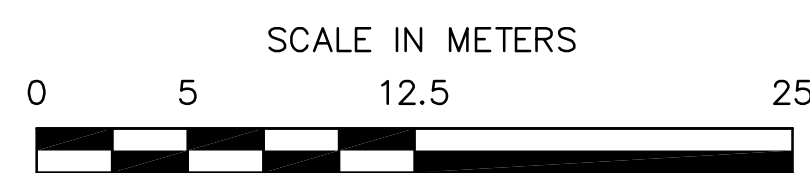
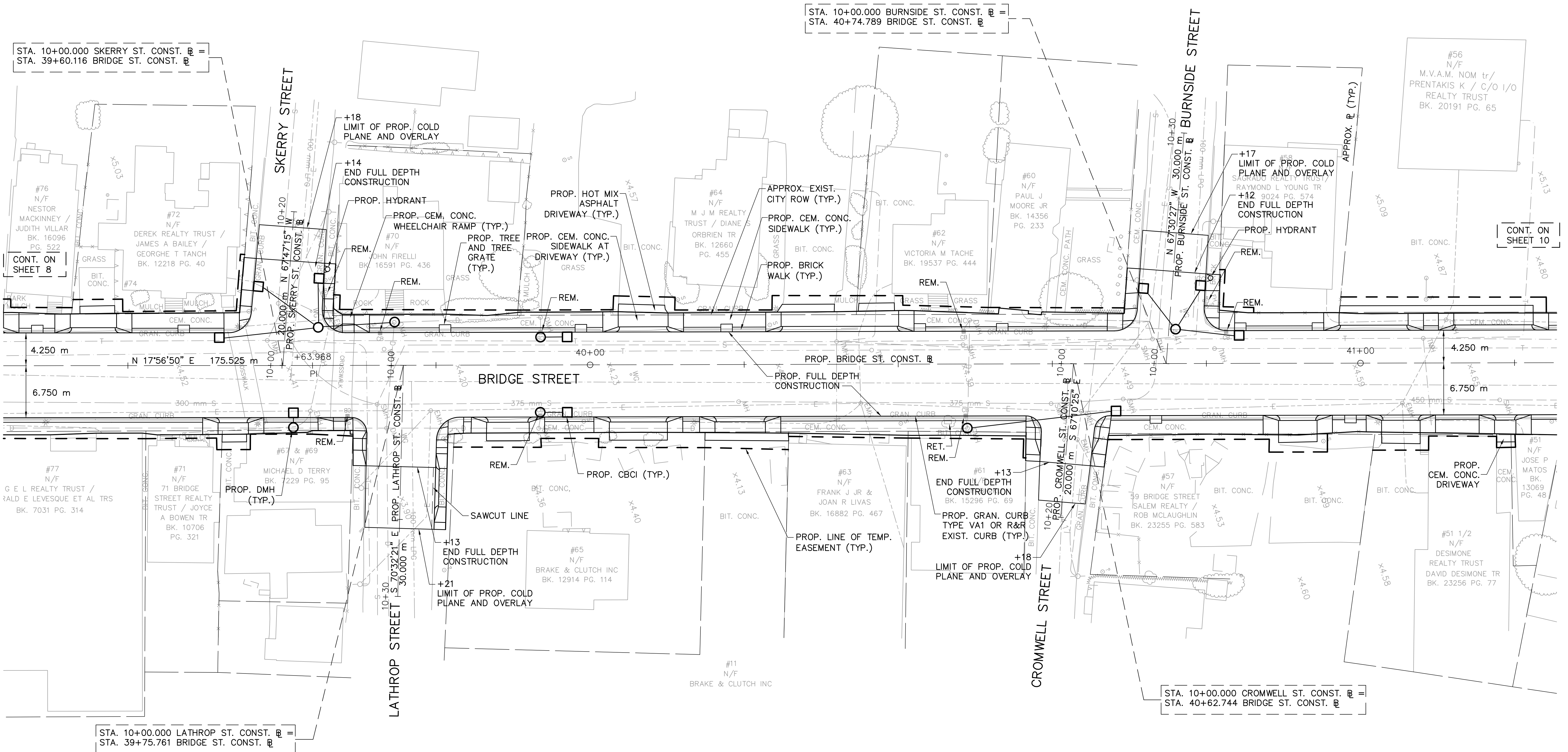
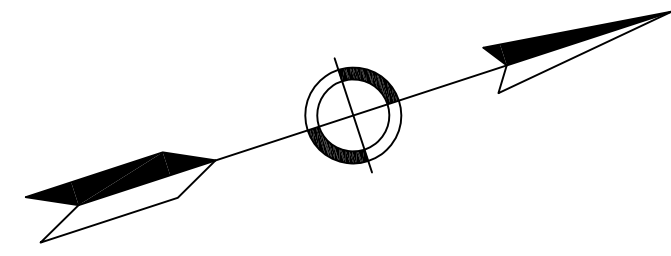

FOR PROFILE: SEE SHEET NO. 17

J:\Project\4985\Trans\Plot\4985P-TGPO5.dwg 12/22/2006 3:48:02 PM EST