

LEGEND

- = REFL. DRUM
- ▨ = TYPICAL DAILY WORK AREA (MULTIPLE AREAS ARE PERMITTED)
- ▤ = STAGE ONE WORK AREA
- ↔ = DIRECTION OF VEHICLE FLOW

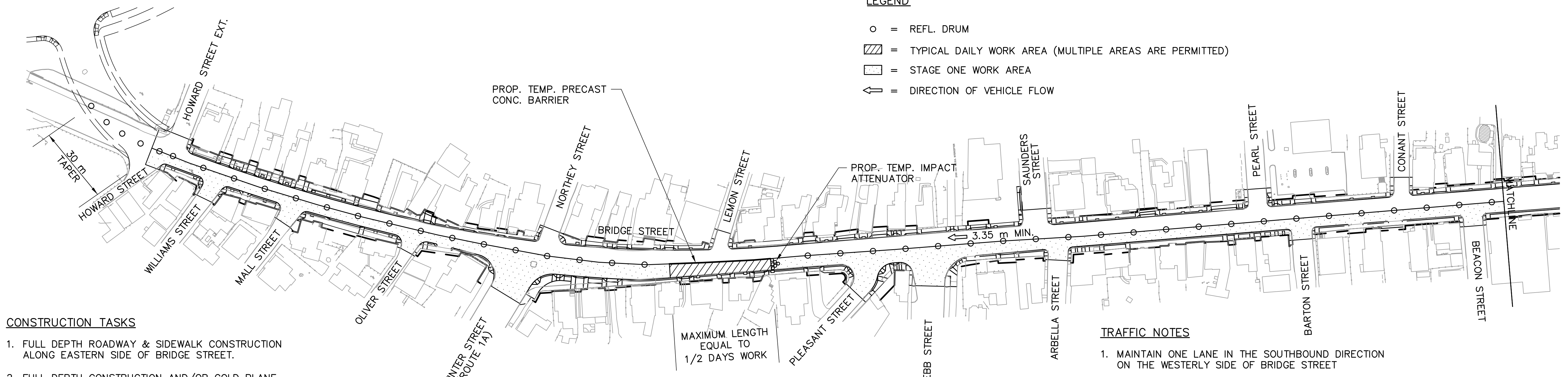

CONSTRUCTION TASKS

1. FULL DEPTH ROADWAY & SIDEWALK CONSTRUCTION ALONG EASTERLY SIDE OF BRIDGE STREET.
2. FULL DEPTH CONSTRUCTION AND/OR COLD PLANE AND RESURFACE (AS REQUIRED) EASTERLY SIDE STREETS.
3. INSTALL NEW WATER SUPPLY PIPES IN EXISTING WATER SUPPLY PIPE LOCATION
4. INSTALL ALL CATCH BASINS & MANHOLES ALONG EASTERLY SIDE OF BRIDGE STREET. INSTALL ALL PARALLEL & LATERAL DRAIN PIPES
5. INSTALL PROPOSED STREET LIGHTING AND LANDSCAPING ALONG EASTERLY SIDE OF BRIDGE STREET
6. INSTALL PROPOSED TRAFFIC SIGNALS

TRAFFIC NOTES

1. MAINTAIN ONE LANE IN THE SOUTHBOUND DIRECTION ON THE WESTERLY SIDE OF BRIDGE STREET
2. MAINTAIN USE OF EXISTING TRAFFIC SIGNALS
3. MAINTAIN ALL EXISTING VEHICLE & PEDESTRIAN ACCESS/EGRESS TO THE ABUTTERS AND BRIDGE STREET SIDE STREETS
4. SEE SHEET 32 FOR ADVANCE CONSTRUCTION SIGNING
5. MAINTAIN A MINIMUM LANE WIDTH OF 3.35 m SOUTH OF RICE STREET AND A MINIMUM COMBINED TRAVEL LANE AND PARKING LANE WIDTH OF 5.85 m NORTH OF RICE STREET

