

SALEM BRIDGE STREET				
STATE	FED. AID	PROJ. NO.	SHEET NO.	TOTAL SHEETS
MASS.			47	81
PROJECT FILE NO. 601017				

CROSS SECTIONS
STA. 33+60 TO 33+80

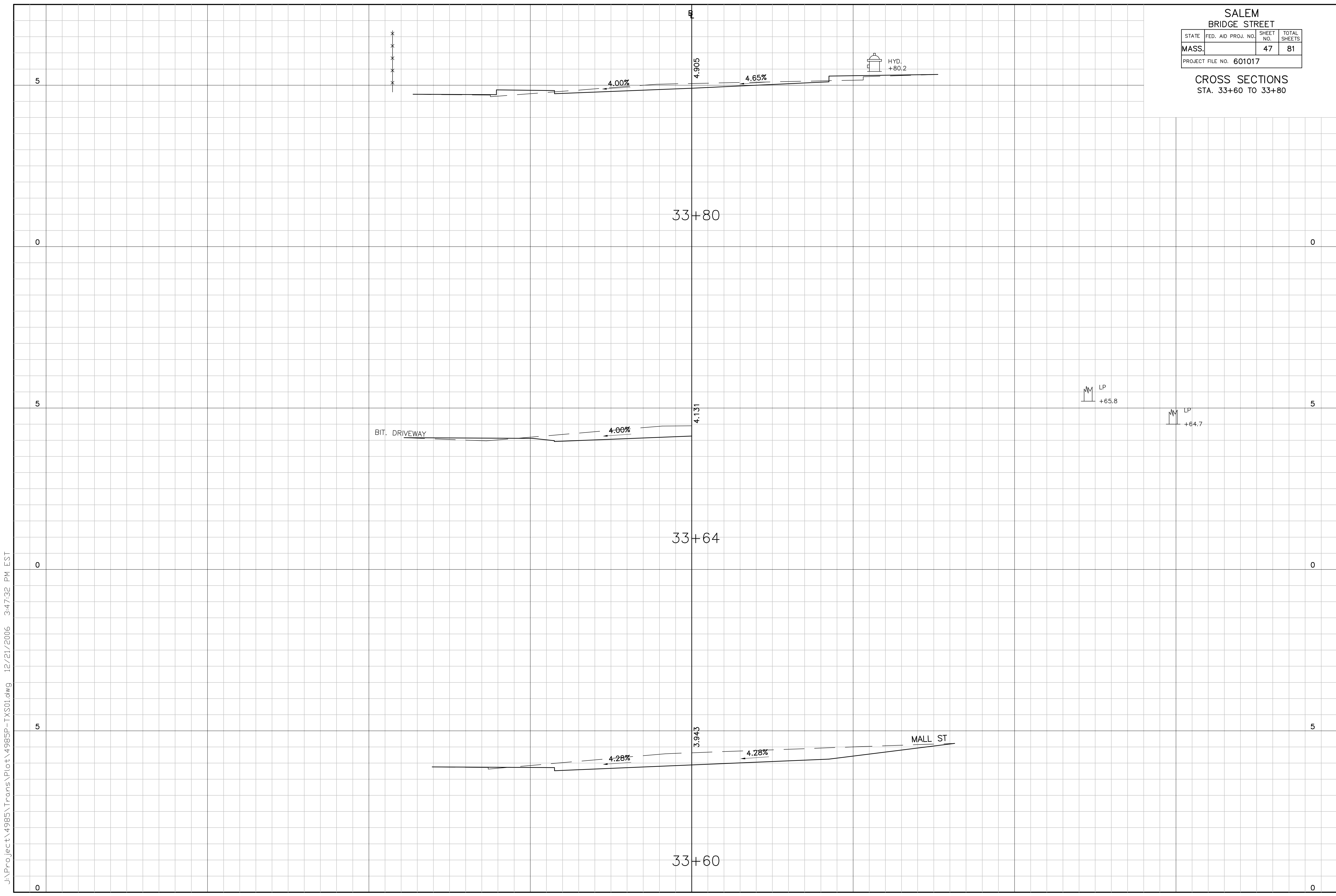

J:\Project\4985\Trans\Plot\4985P-TX501.dwg 12/21/2006 3:47:32 PM EST