

SALEM BRIDGE STREET				
STATE	FED. AID PROJ. NO.	SHEET NO.	TOTAL SHEETS	
MASS.		49	81	
PROJECT FILE NO. 601017				

CROSS SECTIONS  
STA. 34+25 TO 34+40

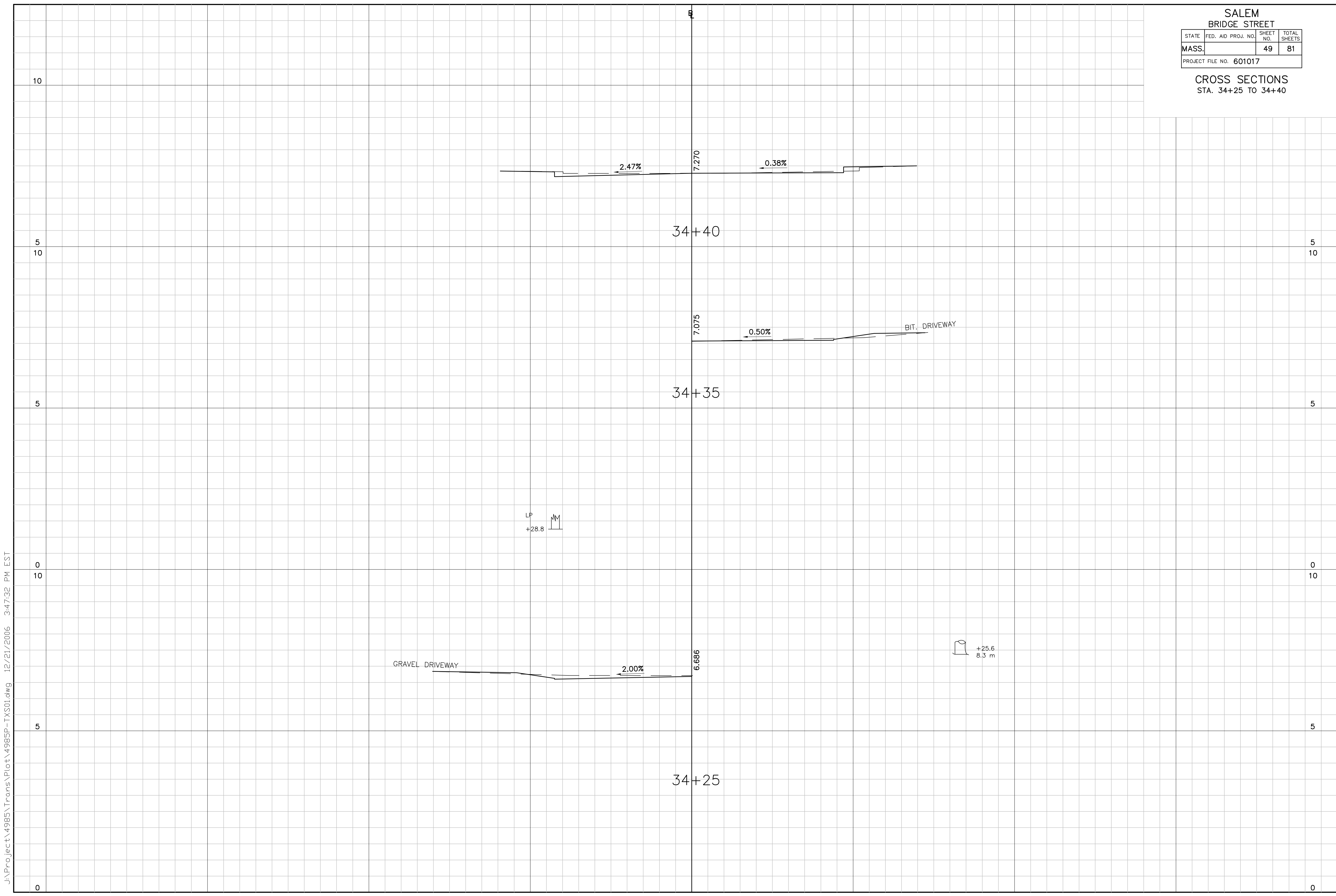

J:\Project\4985\Trans\Plot\4985P-TX501.dwg 12/21/2006 3:47:32 PM EST