

| SALEM BRIDGE STREET | | | | |
|-------------------------|--------------------|-----------|--------------|--|
| STATE | FED. AID PROJ. NO. | SHEET NO. | TOTAL SHEETS | |
| MASS. | | 62 | 81 | |
| PROJECT FILE NO. 601017 | | | | |

CROSS SECTIONS
STA. 38+60 TO 38+80

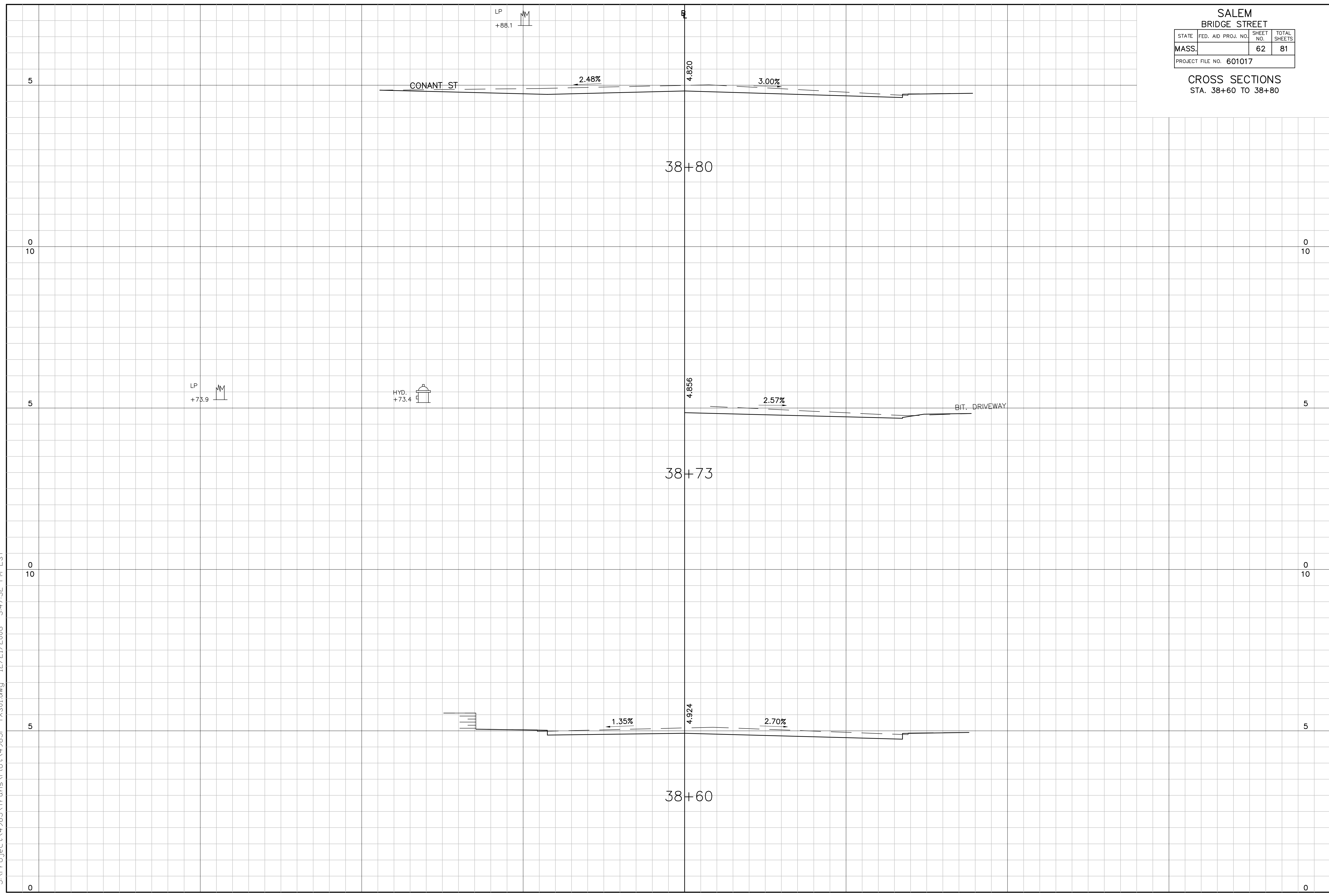

J:\Project\4985\Trans\Plot\4985P-TX501.dwg 12/21/2006 3:47:32 PM EST