

- Bridge St. By-pass Project - Under Construction
- Route 114/North Street - Under Construction
- Bridge Street - Flint to Washington - Preliminary Design

- MBTA Update
  - In May 2007, Earth Tech Architecture was engaged by the Massachusetts Bay Transportation Authority (MBTA) to conduct a feasibility study with specific planning tasks based on the previous design work to help identify the following for the development:
    - possible mixed-use development opportunities;
    - provide market analysis on the economic viability of potential non-parking uses; and
    - develop rough planning diagrams of possible building/parking configurations for preliminary planning purposes.

## OPTION 1

- 1,012 Parking Spaces
- 20,000 GSF of Office Space
- Maintains Washington / Bridge Street Intersection As An Active Vehicular Access Point

## OPTION 2

- 1,226 Parking Spaces
- 23,000 SF of Retail Space
- 30,000 SF of Office Space
- 7,500 SF of Restaurant Space
- Eliminates Traffic At The Washington / Bridge Street Intersection

# **J. Michael Ruane Judicial Center & Salem Trial Courts**

***“North Street Construction Stages,  
Pedestrian Access and Traffic Control”***

**March 10, 2008**





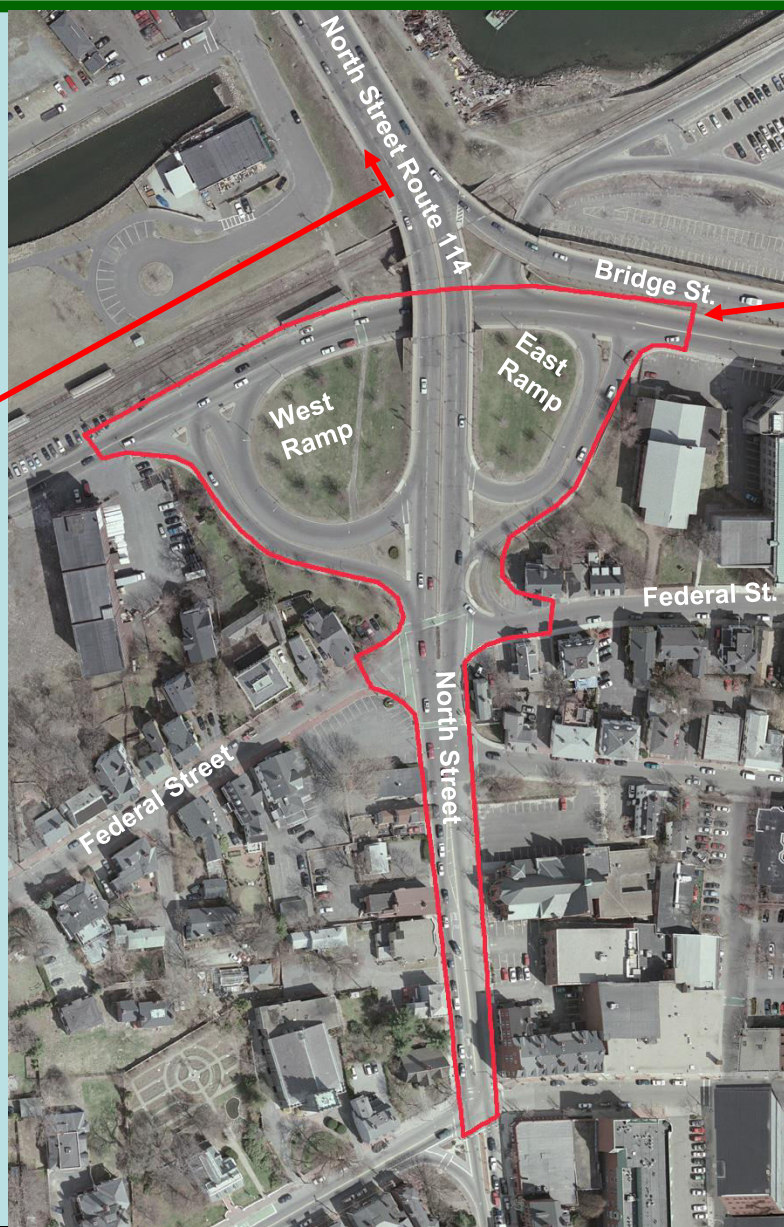







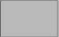
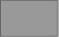

**MHD North  
Street Project  
Complete  
Summer 2008**



**Roadway  
Project Limits**

**Roadway Project  
Has Been  
Coordinated With:**

- MHD North St.
- MHD Bridge St.
- MHD Bypass
- MBTA Garage
- City of Salem

-  **WIDENED RAMP (193 S.F.) (4.5 FT MAX.)**
-  **COLD PLANE AND OVERLAY EXIST. PAVEMENT**
-  **EXISTING PAVEMENT**
-  **NEW SIDEWALK**
-  **EXISTING SIDEWALK/ISLAND**
-  **PROPOSED LANDSCAPED AREA (543 S.F.)**
-  **22 PROPOSED TREES** (EXACT LOCATION AND TYPE TO BE DETERMINED BY CITY)
-  **EXISTING TREES**
-  **EXIST. LANDSCAPE TO REMAIN**
-  **TEXTURED PAVED ISLAND (770 S.F.)**
-  **TRAFFIC SIGNAL**
-  **PEDESTRIAN SIGNAL**
-  **ORNAMENTAL STREET LIGHTS**





## Textured Paved Islands

- DCAM Worked With The City And Is Using The Same Textured Pavement Material Currently Used In Other Areas Of The City.

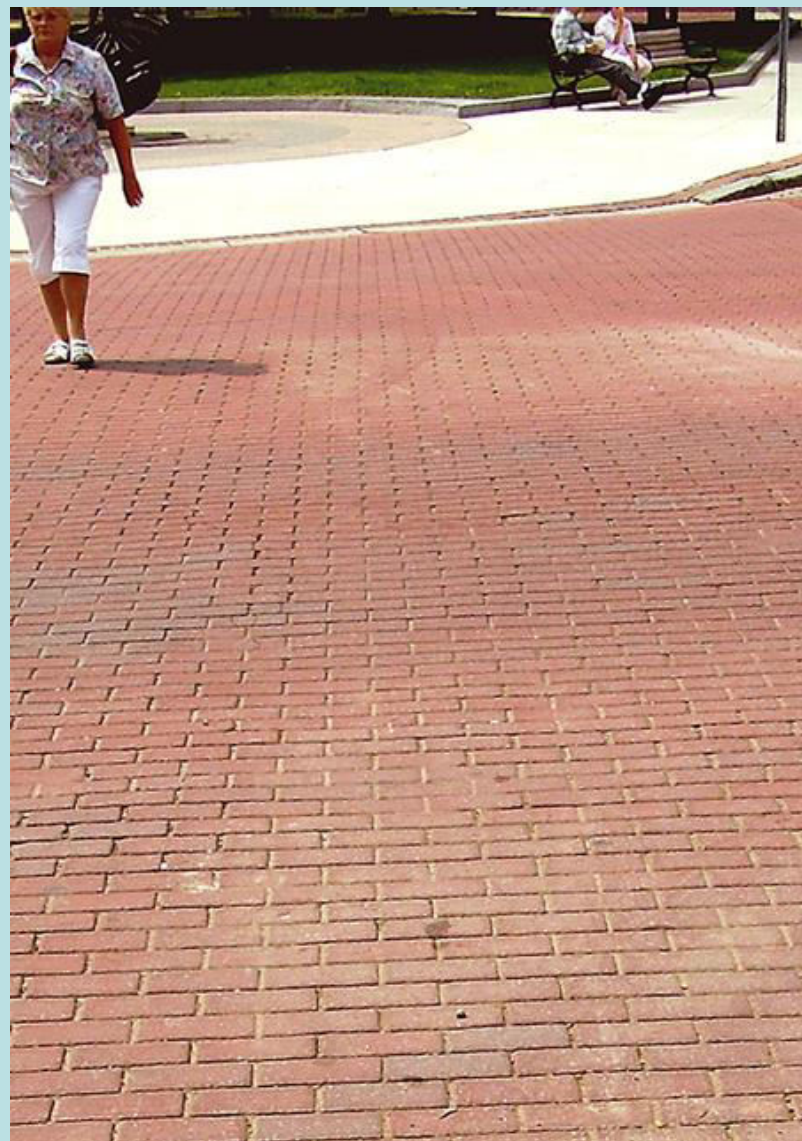

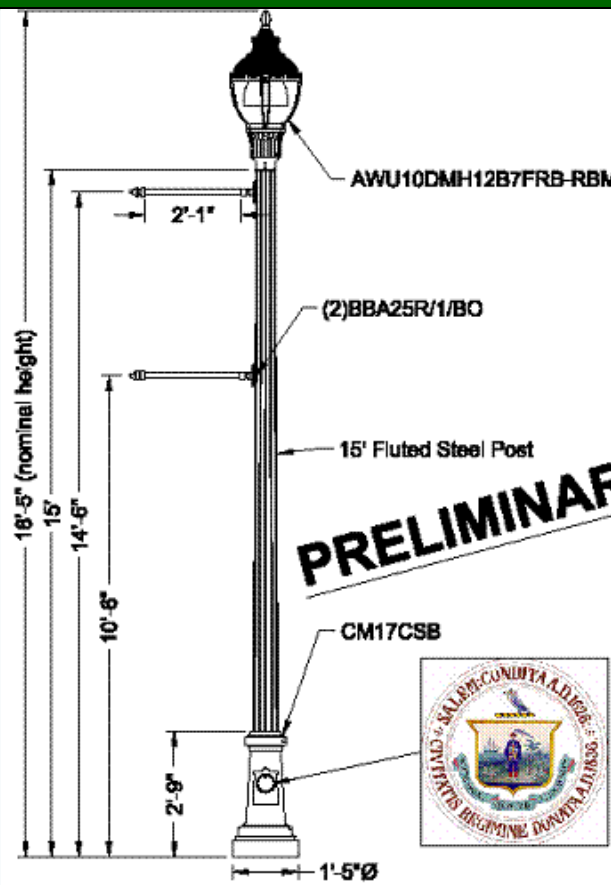

## New Ornamental Street Lights and Traffic Signals

- Ornamental Street Lights Extended On West Ramp and To Essex Street.
- New Pavement, Markings and Lights on North Street To Essex Street.

# Ornamental/Period Type Lighting and Traffic Signals



- Traffic Signals to Match Street Lights
- Currently Being Installed on North Street

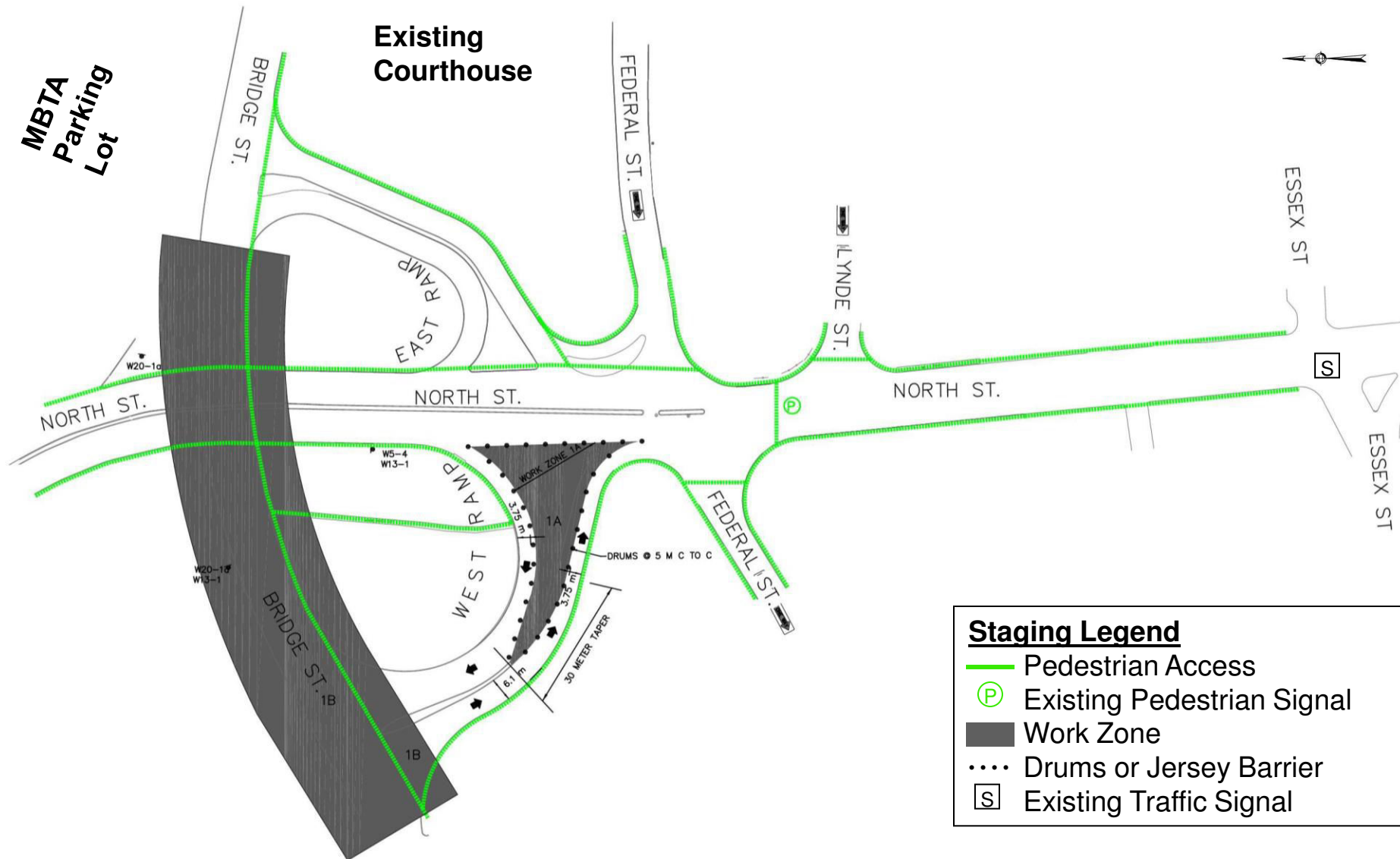

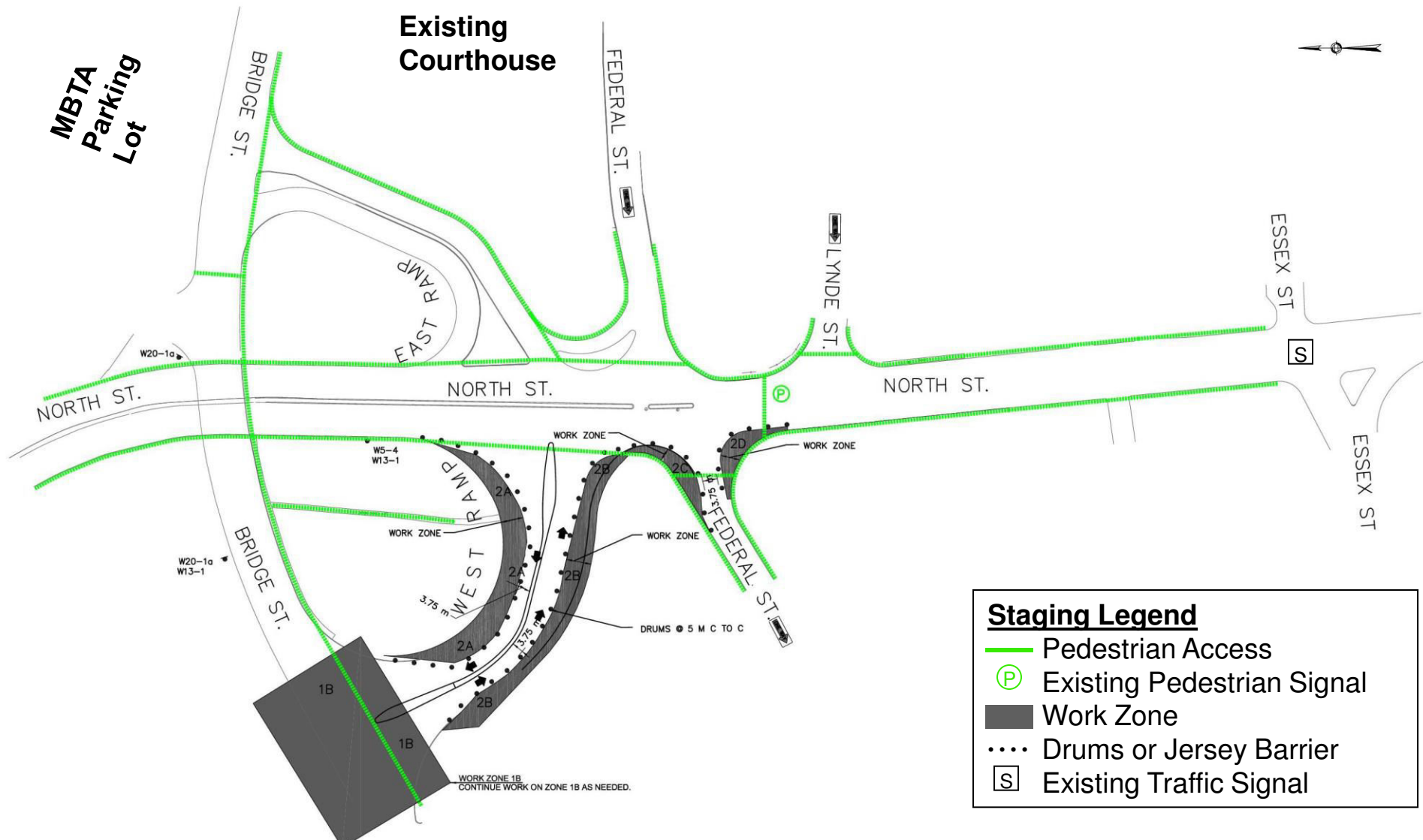

## Staging Legend

- Pedestrian Access
- Ⓟ Existing Pedestrian Signal
- Work Zone
- .... Drums or Jersey Barrier
- S Existing Traffic Signal

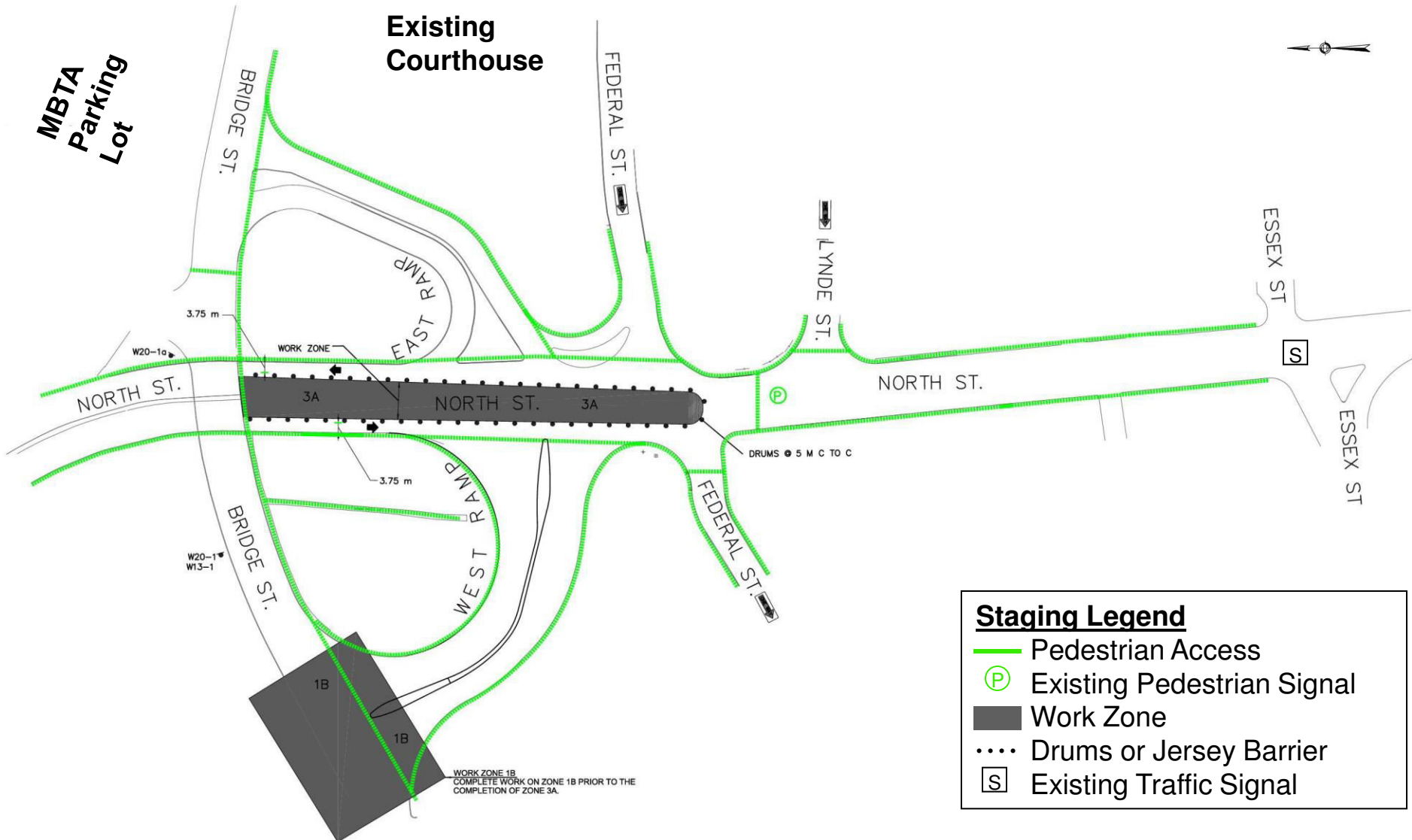

## Staging Legend

- Pedestrian Access
- Ⓟ Existing Pedestrian Signal
- Work Zone
- ⋯ Drums or Jersey Barrier
- S Existing Traffic Signal

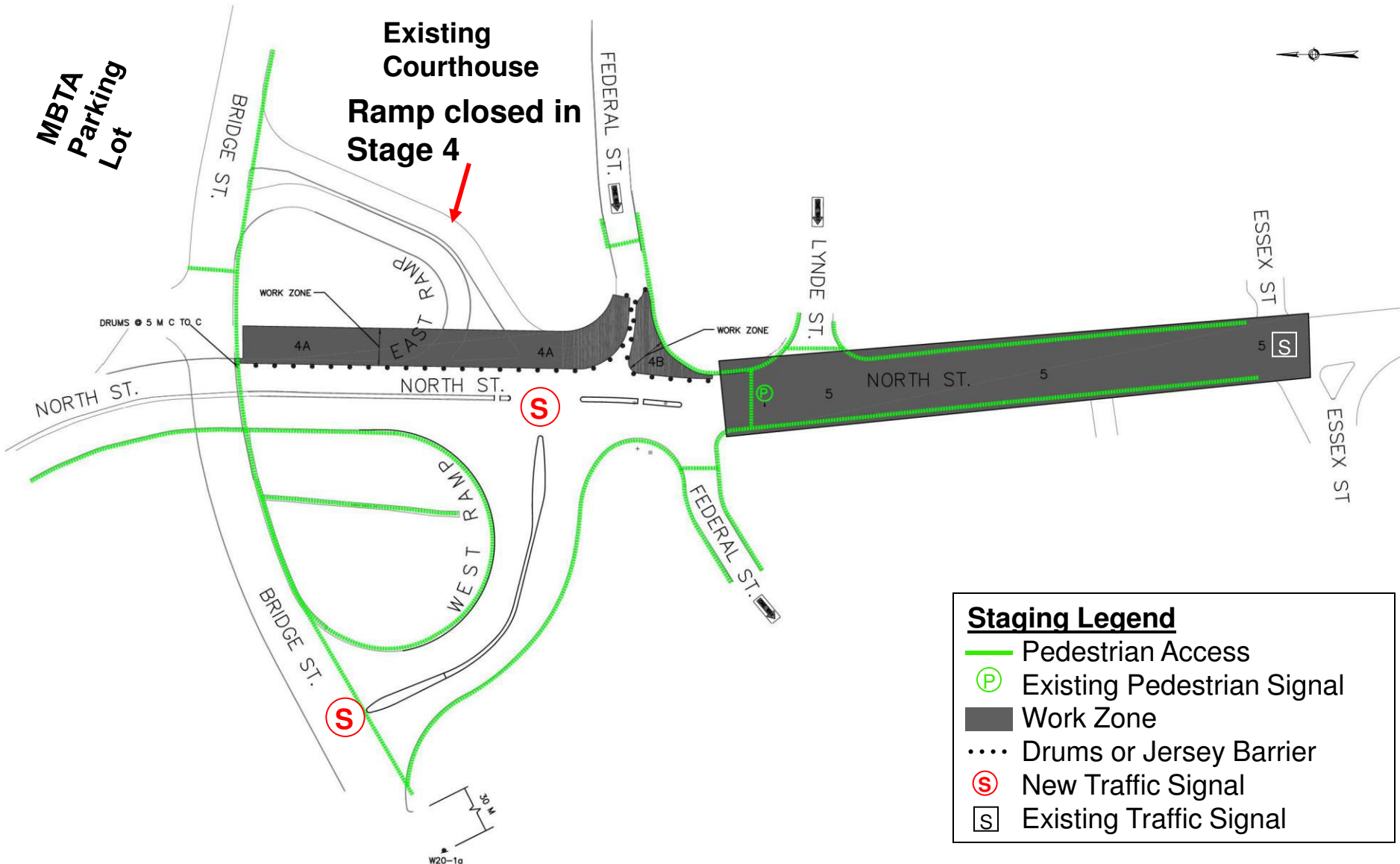

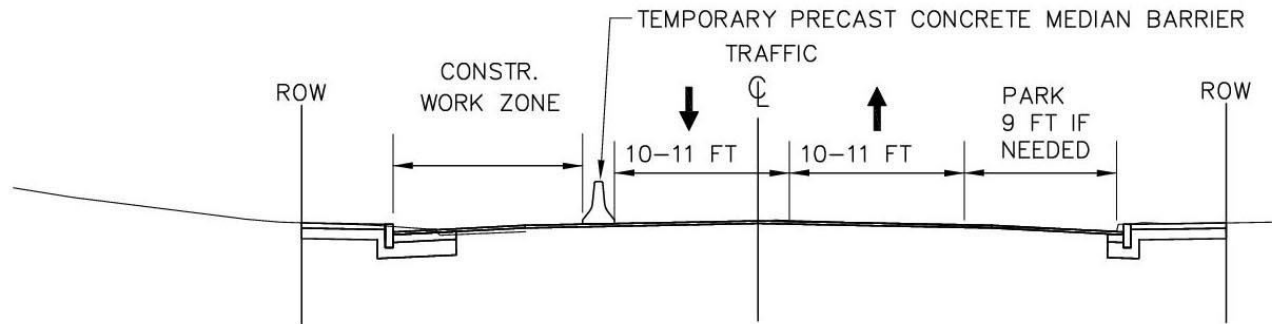

BOX WIDENING LANE CLOSURES  
TEMPORARY LANE CONFIGURATION — LONG DURATION

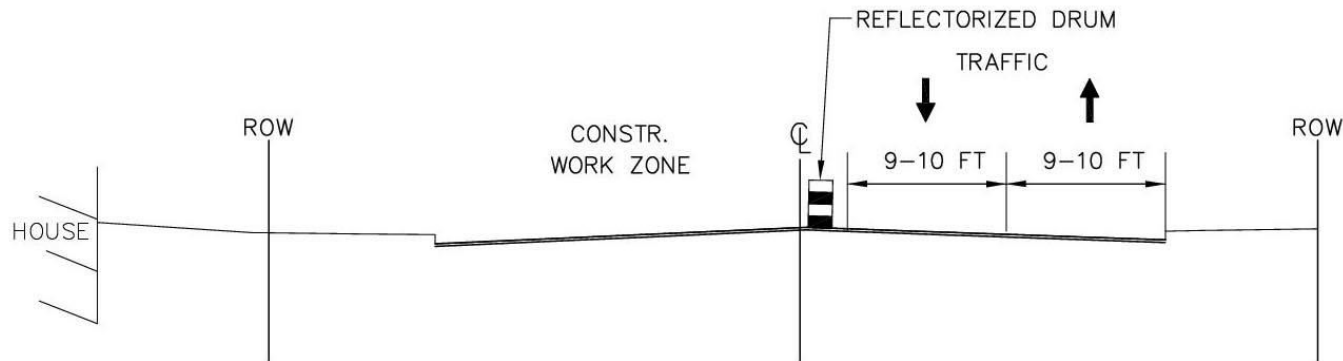

COLD PLANE AND RESURFACING OPERATIONS LANE CLOSURES  
TEMPORARY LANE CONFIGURATION — SHORT DURATION

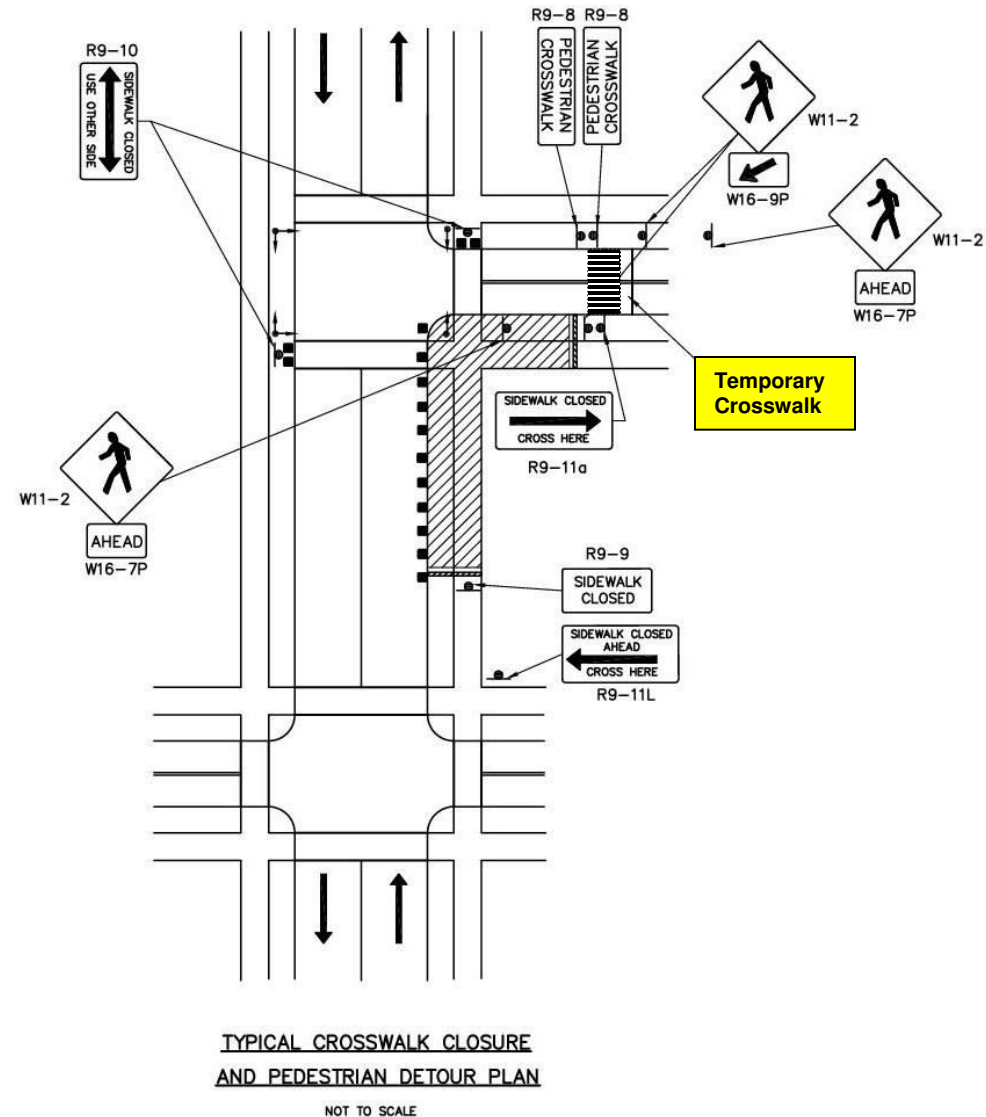
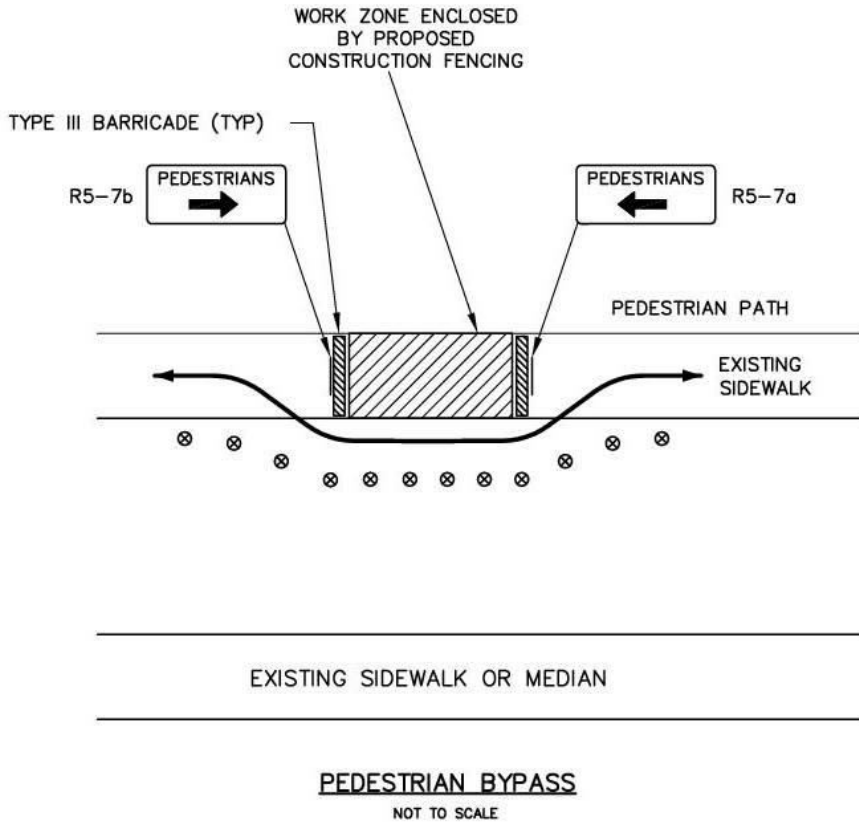



- Construction
  - Site Access
  - Parking





- Salem Website
  - Construction Information
  - Website address – [www.salem.com](http://www.salem.com)
  - Updates On Construction Stages

# **J. Michael Ruane Judicial Center & Salem Trial Courts**

***“North Street Construction Stages,  
Pedestrian Access and Traffic Control”***

**March 10, 2008**