

History of F.W. Webb in Salem

- First opened Salem branch on Endicott Street in 1944 over 70 years ago
- Branch was moved in the early 1950s to its current location, 295 Bridge Street to allow for a railroad station to be constructed on the site of the Endicott Street location



F.W. Webb Salem Today



Looking to the Future

Building a new facility will allow us to grow our business in Salem

Current Facility

- No showroom
- Small counter area
- 5-Story warehouse
- 14 Current employees



New Proposed Facility

- Showroom
- Self-Serve wholesale area
- Single-story high-bay warehouse
- Addition of 8-10 full-time employees
- F.W. Webb moves all operations to new facility, allowing for redevelopment of existing facility

History of Bridge Street Site

Former Universal Steel Facility



Current Street View



Alpha Auto Site



Proposed Building – Project Overview

- Entrances, parking areas, loading docks, very small outside storage area
- Alpha Auto Site also being cleaned up
- Utility easement
- Pedestrian & vehicle access easement



Access to Beckford & River Street

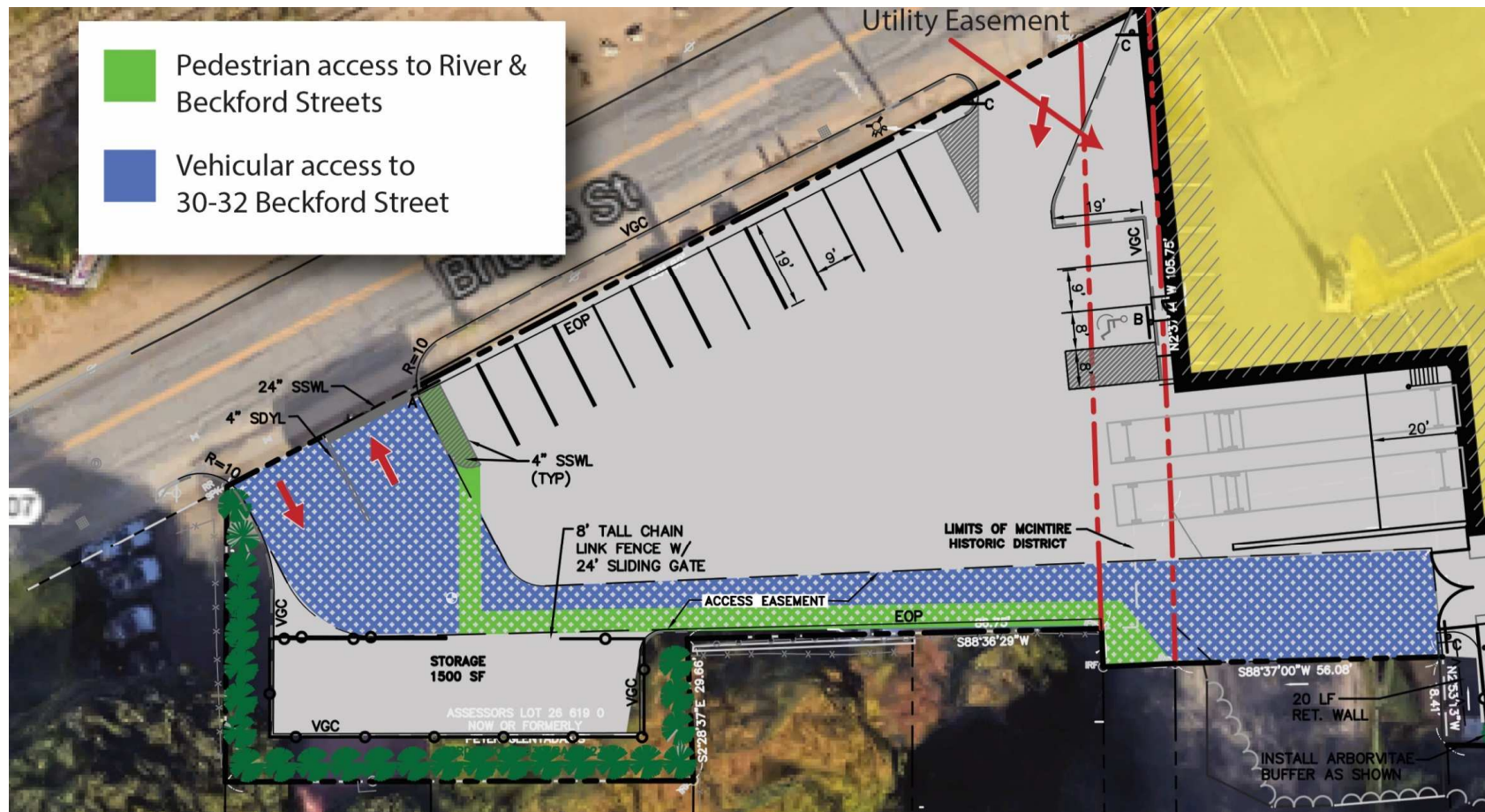

Proposed Building – First Floor

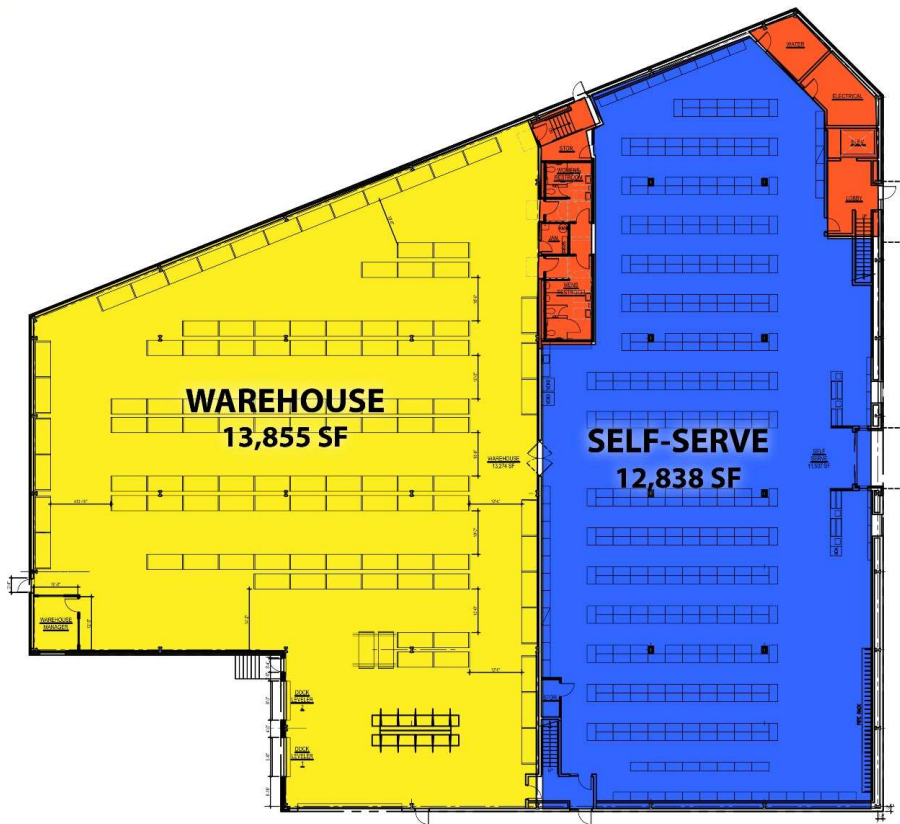

Proposed Building – Second Floor

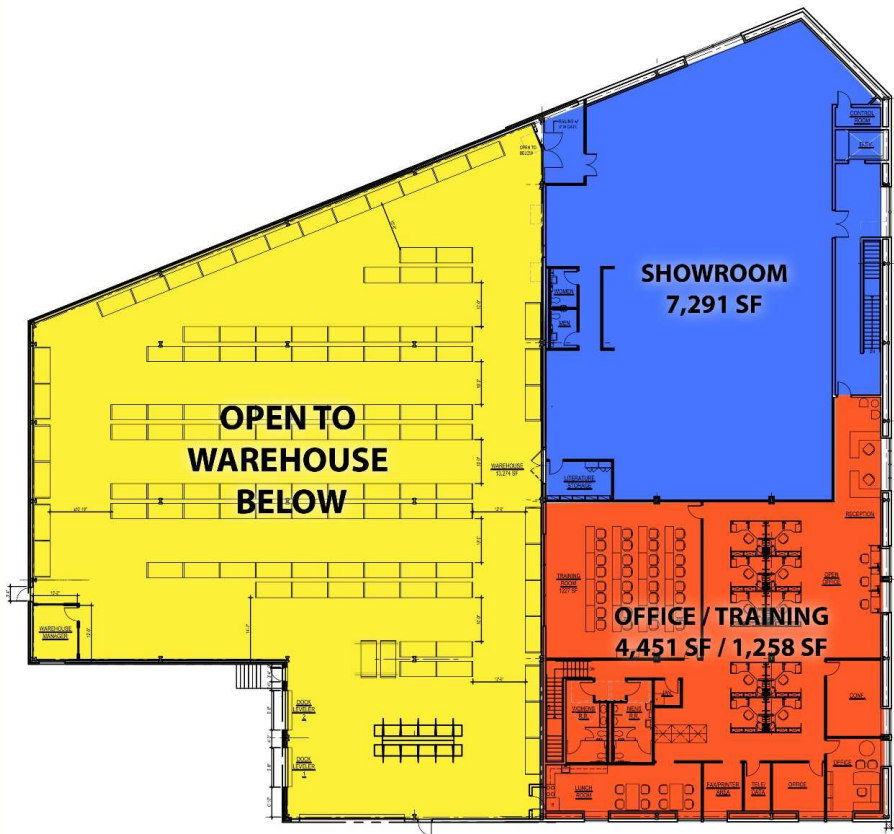

Benefits for the City of Salem

- Significant tax revenue increase for the City
- Brings new jobs to Salem
- Keeps existing F.W. Webb jobs local
- Additional environmental cleanup at Universal Steel site
- Three (3) Bridge Street properties will be redeveloped

Elevation Rendering



VIEW FROM BRIDGE STREET